



# LED Dock Light+Fan

HIGH LIGHT · DURABLE · SAVE COST





Adopting an integrated compact design, the lamp body and fan module are combined and arranged together to reduce space occupation, making it easy to install in positions such as dock cranes, cargo warehouse columns, and container tops. The shell is made of high-strength and corrosion-resistant aluminum alloy or stainless steel material, with a surface treated with anti-corrosion coating to resist sea breeze and salt spray erosion, and adapt to high humidity and high salinity environments along the coast.

## ► Benefits

### ☑ Efficient and energy-saving:

LED light sources save over 60% of energy compared to traditional lighting fixtures, with a lifespan of up to 50000 hours; The fan motor adopts DC frequency conversion technology, which has low energy consumption and flexible speed regulation. It supports multi speed adjustment to meet different working conditions.

### ☑ Safety protection:

The protection level of the whole machine is above IP65, with waterproof, dust-proof and anti-collision performance, which can operate stably in rainstorm, typhoon and other severe weather; The electrical part adopts leakage protection and overload protection design to ensure safe use; The fan cover is made of fine metal mesh to prevent foreign objects from getting caught up and to avoid injuring the operators.

## ► Product Picture



## DATA SHEET(Light)

| Power             | 7W   | 10W          | 14W          | 18W          |
|-------------------|--|--------------|--------------|--------------|
| Model             | BB-MTD-7W-D  | BB-MTD-10W-D | BB-MTD-14W-D | BB-MTD-18W-D |
| Dimension(mm)     | 1248*283*281   | 1248*283*281 | 1248*283*281 | 1248*283*281 |
| Luminous Flux     | 910lm  | 1300lm       | 1820lm       | 2340lm       |
| Beam Angle        | 120°   |              |              |              |
| Materials         | Aluminum Alloy + Galvanized Pipe                         |              |              |              |
| Luminous Efficacy | 130LM/W  |              |              |              |
| Operation Temp    | -40 To + 45°C  |              |              |              |
| CCT               | 2700K SW/3000K WW /4100K NW/5000K DW/5700K CW /6500K SCW |              |              |              |
| CRI               | 80+  |              |              |              |
| Life Span         | 50,000 Hours at 25°C                                     |              |              |              |
| Voltage           | 100-240VAC / 50-60HZ                                     |              |              |              |
| Driver            | Built-in Power Supply                                    |              |              |              |
| Dimming           | No   |              |              |              |
| Sensor            | Without  |              |              |              |
| Control System    | Without  |              |              |              |
| Color             | Yellow   |              |              |              |
| Luminous Source   | 2835 SMD LED   |              |              |              |
| IP Rating         | IP 65  |              |              |              |
| PF                | >0. 9  |              |              |              |
| Warranty          | 3 Years  |              |              |              |

## DATA SHEET(Fan)

| Parameter           | Description   | Remark   |
|---------------------|---|--|
| Product             | 16 inch metal ceiling fan (ordinary non waterproof) | AC MOTOR<br>ENCLOSE<br>OUTDOOR USE<br>BEARING<br>THERMOS |
| Model               | FW-16   |  |
| Blade               | 3 Iron Leaf   |  |
| Surface Treatment   | Baking Paint(Black)                                 |  |
| Motor               | 110*16mm-Copper clad aluminum wire                  |  |
| Motor Bearing       | 6200Z   |  |
| Voltage             | 220   | VAC  |
| Frequency           | 50  | Hz   |
| Current             |   | A  |
| Power               | 110   | W  |
| No.Of Speed         | 3   |  |
| Motor Rpm           | 1350  | RPM  |
| Air Volume          | 3000  | XFM  |
| Noise               | 60  | DB   |
| Product Weight      | 4.5   | KG   |
| Gross Weight        | 5.0   | KG   |
| Power Cord Lenght   | 200   | CM   |
| Product Size        | 17.2*50*52  | CM(W x L x H)  |
| Quantity Per Carton | 1   | Pcs  |

► Order Information

Model:BB-MTD-XXXW-D

| A                       | B                    | C        | D            | E                         | F               | G                 | H          | I                | J              |
|-------------------------|----------------------|----------|--------------|---------------------------|-----------------|-------------------|------------|------------------|----------------|
| Rated Power             | Input Voltage        | Control  | Dimming      | CCT                       | CRI             | LED CHIP          | Beam Angle | Color            | Specification  |
| 7W<br>10W<br>14W<br>18W | Blank-<br>100-240VAC | Not Have | Blank-<br>No | Blank-<br>2700K-<br>6500K | Blank-<br>Ra80+ | Blank-<br>2835SMD | 120°       | Blank-<br>Yellow | 1248*283*281mm |

► Sdy Light Parameter Display

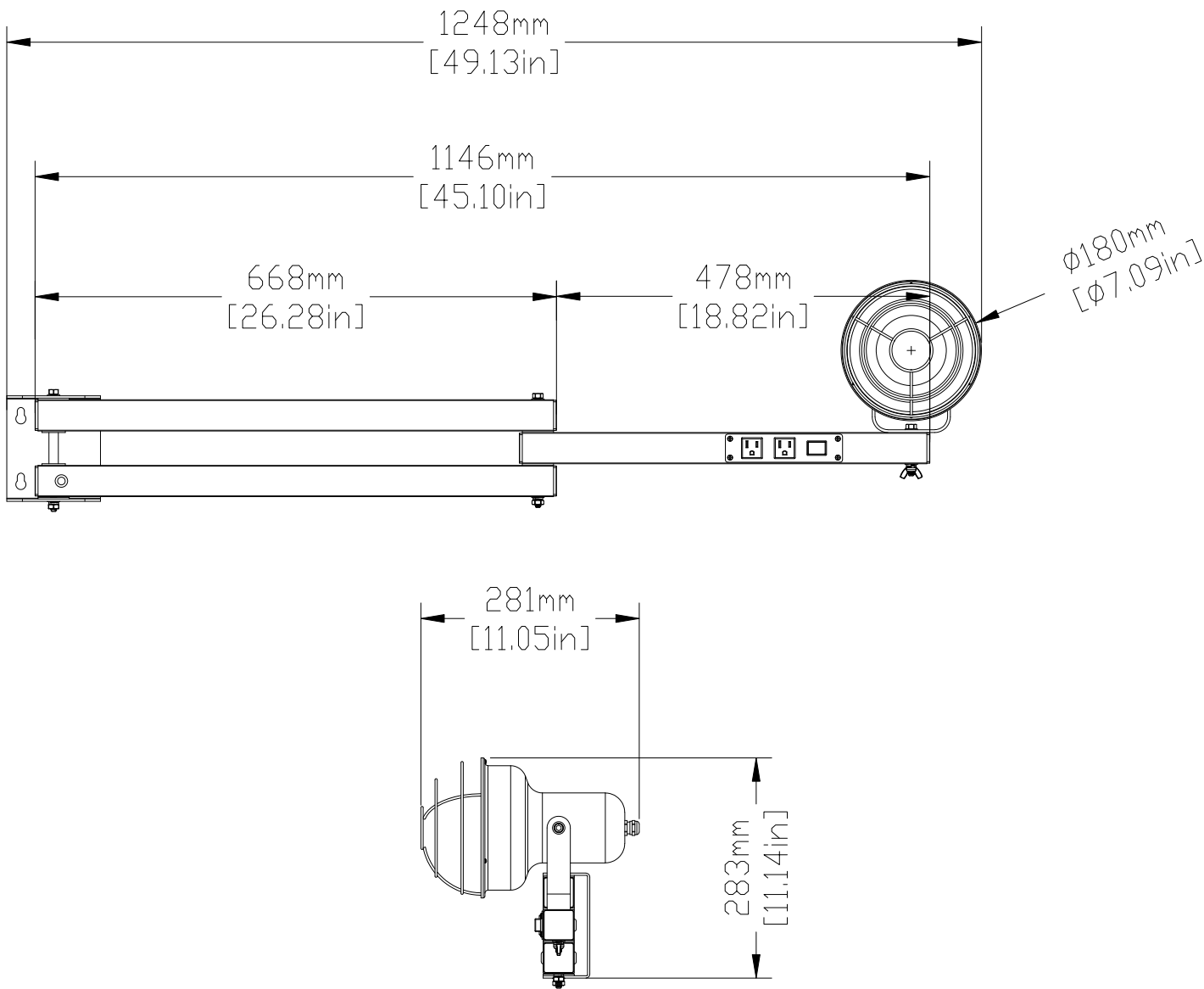

## ► Surface Of Intensity Distribution

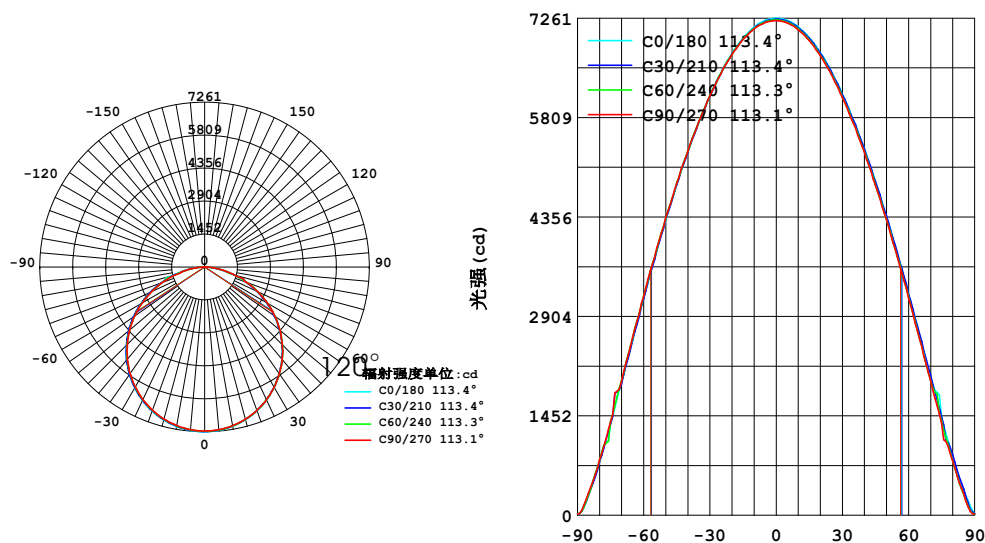

## ► Application case

1. Factory Lighting.
2. Dock Lighting.
3. Warehouse Lighting.
4. Goods shelf Lighting.
5. Container Lighting.

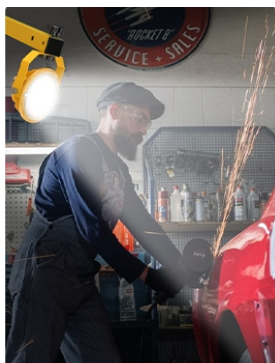

Garage



Truck Ramps



Loading And



Dock Sites



Workshops

## ► Optics

### Tech.Support:

Tell us the place/L,W and usage,we have an engineer team to respond the DIALUX for lights quantity and effects, IES files are available upon request.

