

LED L4 Street Lamp

30-120W



Color



- Patented private mold, integrated die-cast aluminum housing.
- High luminous efficacy, with a luminous efficacy of up to 200lm/w.
- Professional anti-glare lenses are adopted :PC full cut-off lenses T2S/T2M/T3M.
- Functions such as 0/1-10V dimming, time control, light sensing, and Internet of Things control are optional.
- The integrated lens and tempered glass panel are compatible with each other and fixed without glue.
- The protection grade reaches IP66/IK08.
- Snap-on installation, tool-free disassembly.
- The horizontal positioning instrument is easy to install.

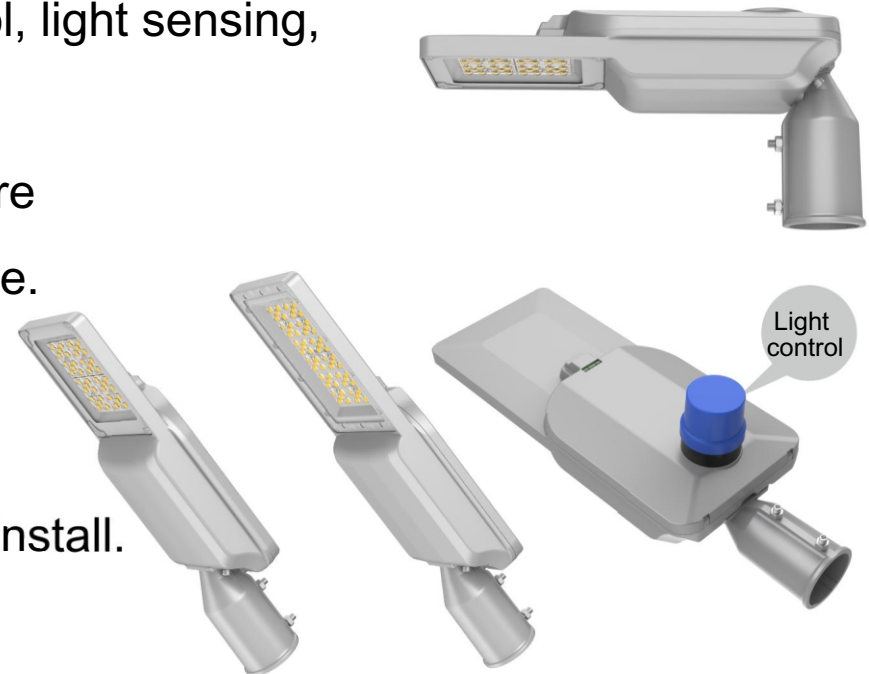

Product size

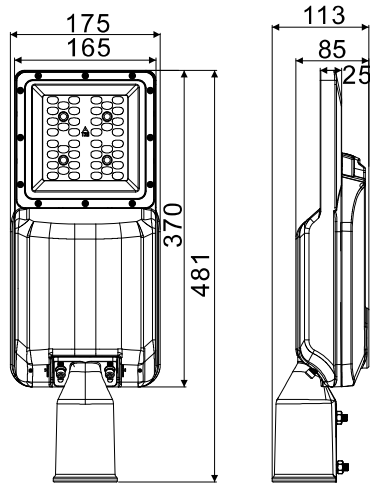

30-60w (Lens model)

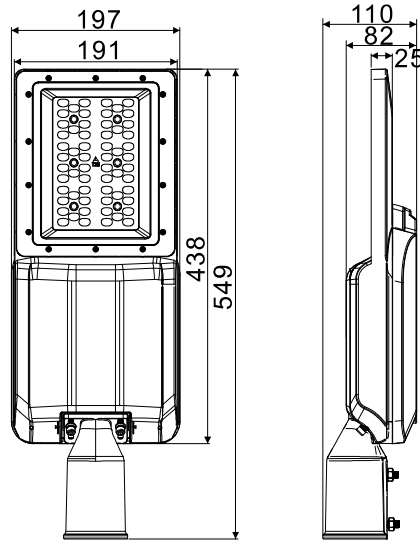

70-80w (Lens model)

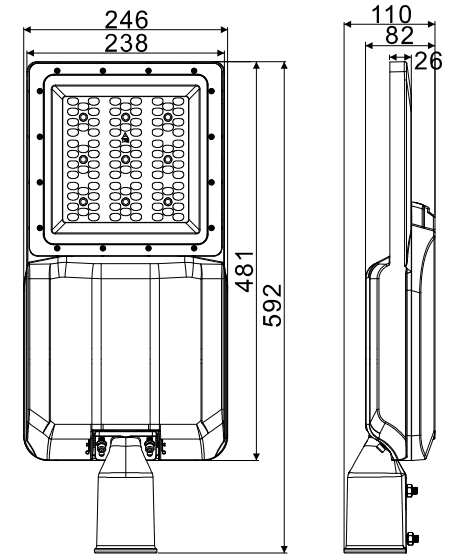

90-120w (Lens model)

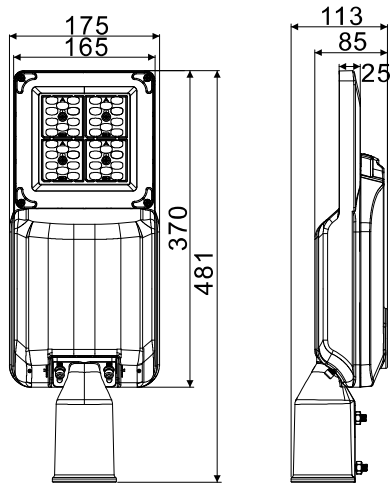

30-60w (Glass style)

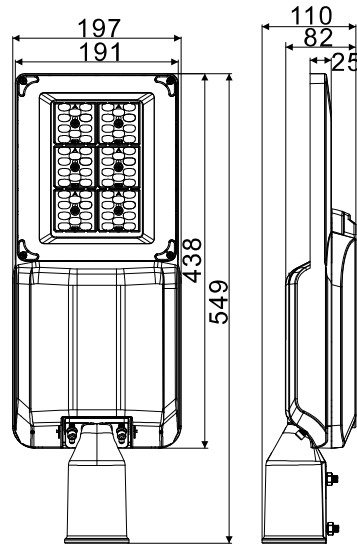

70-80w (Glass style)

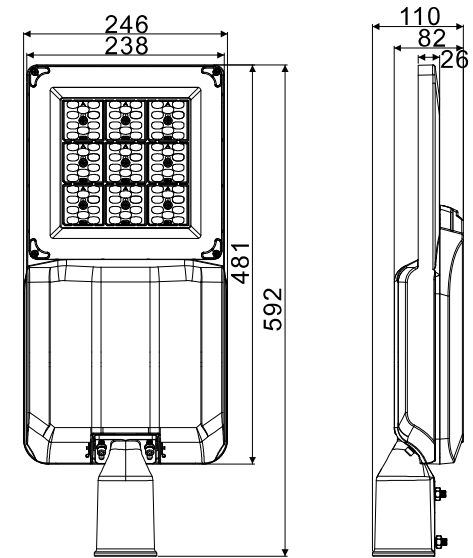

90-120w (Glass style)

unit : mm

Product size (With intelligent control)

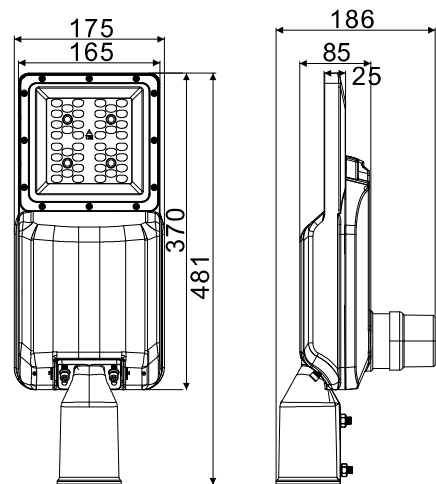

30-60w (Lens model)

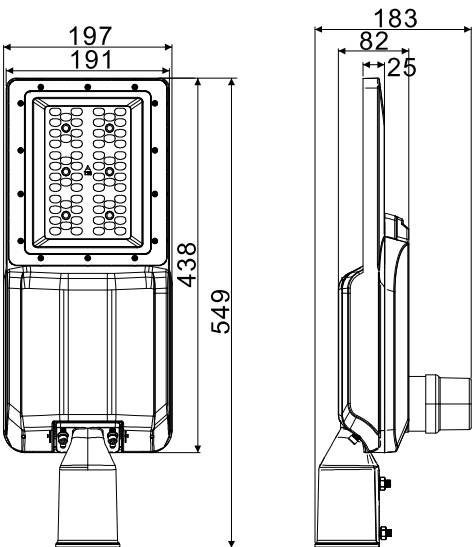

70-80w (Lens model)

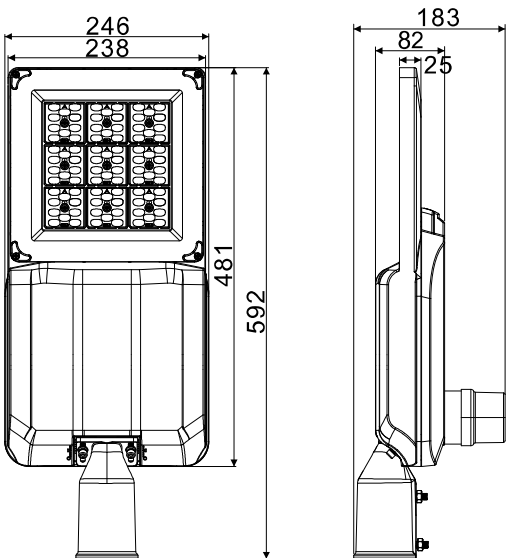

90-120w (Lens model)

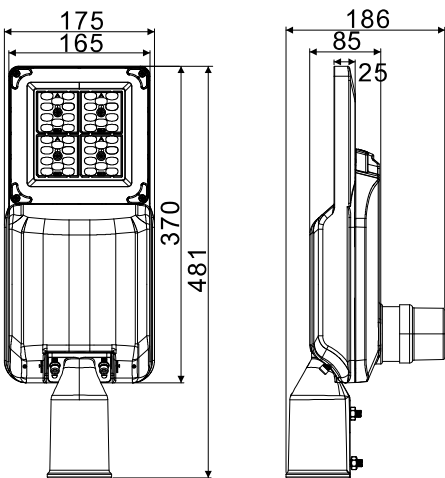

30-60w (Glass style)

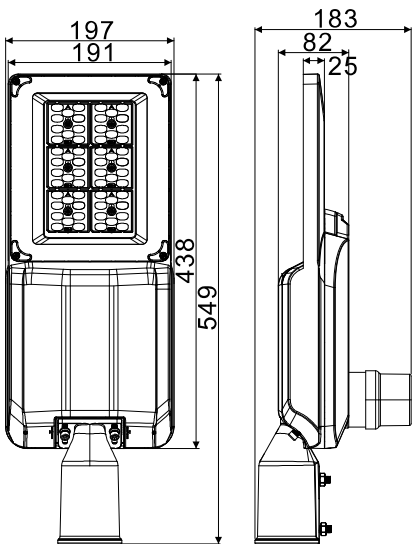

70-80w (Glass style)

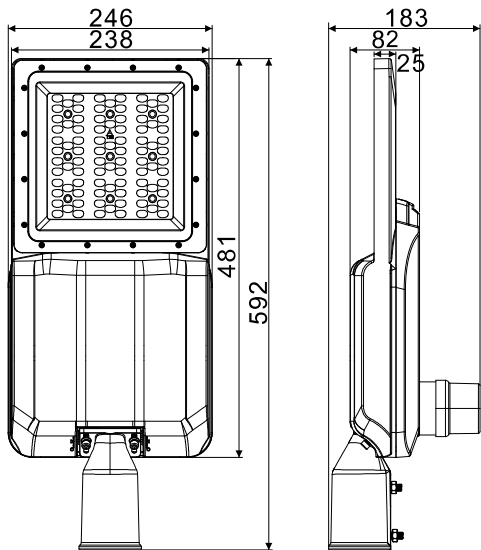

90-120w (Glass style)

unit : mm

Install the shaft

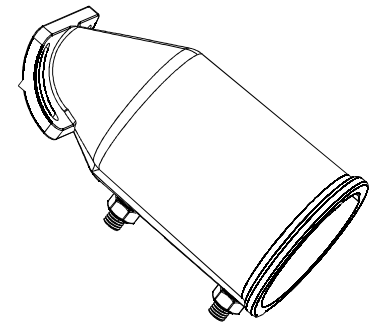
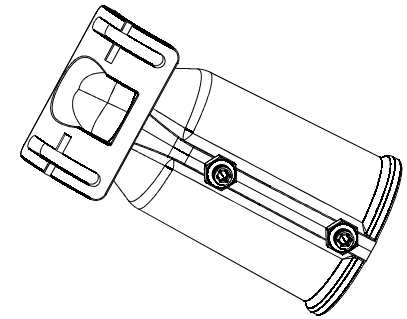
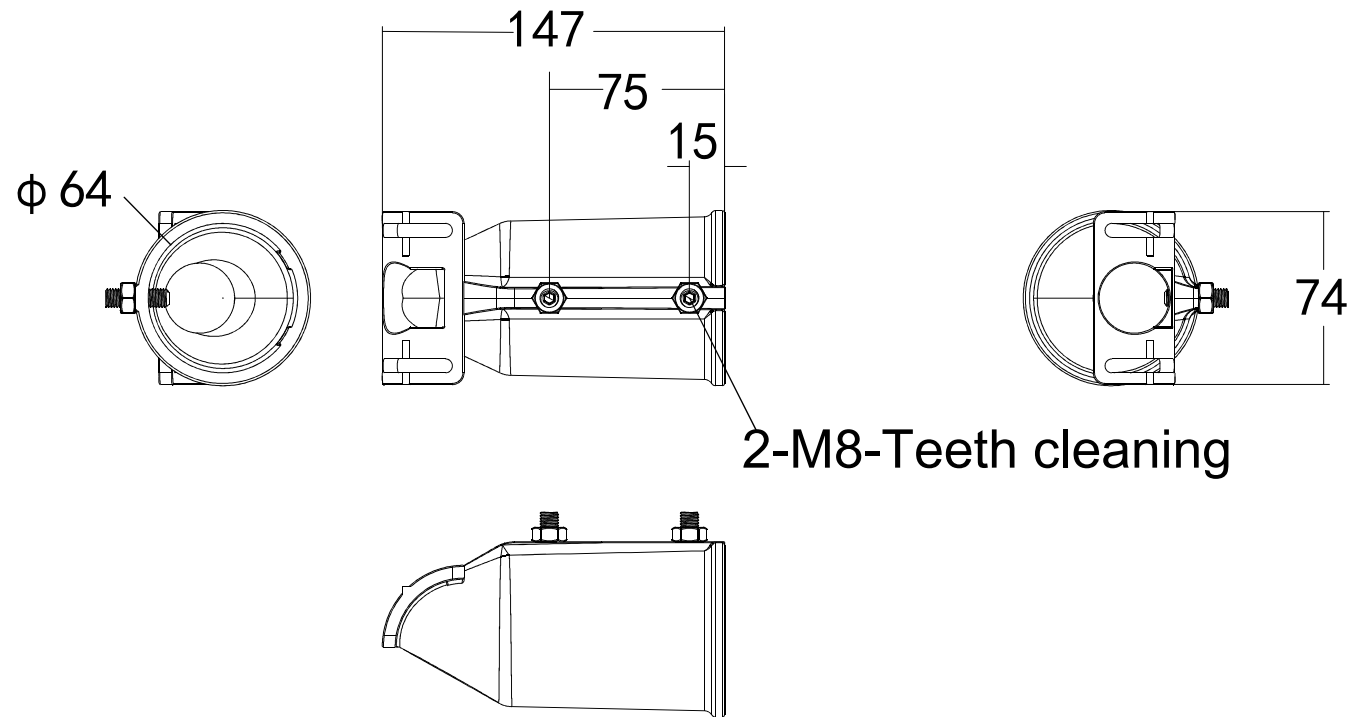

60MM installation hole

unit : mm

Install the shaft

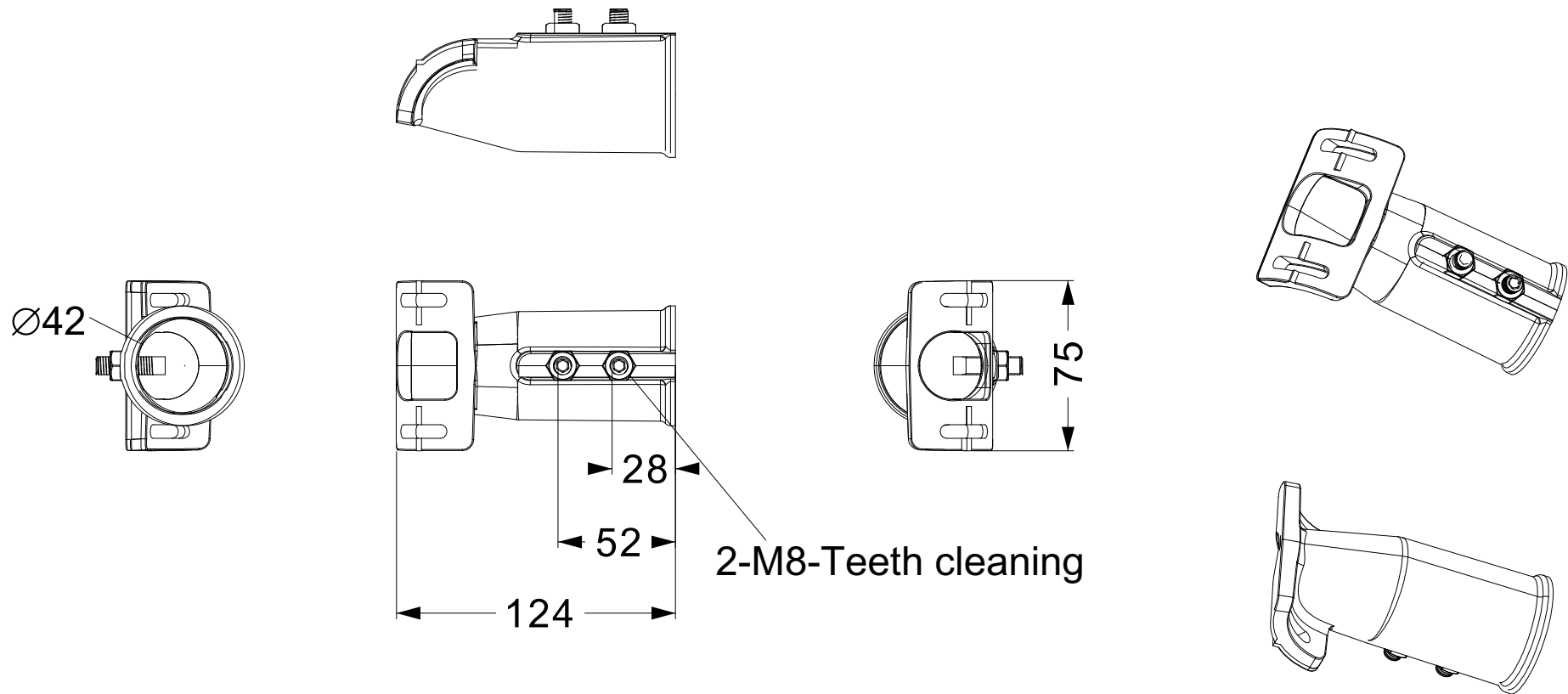

42MM installation hole

unit : mm

Bill of Materials (Lens Type)

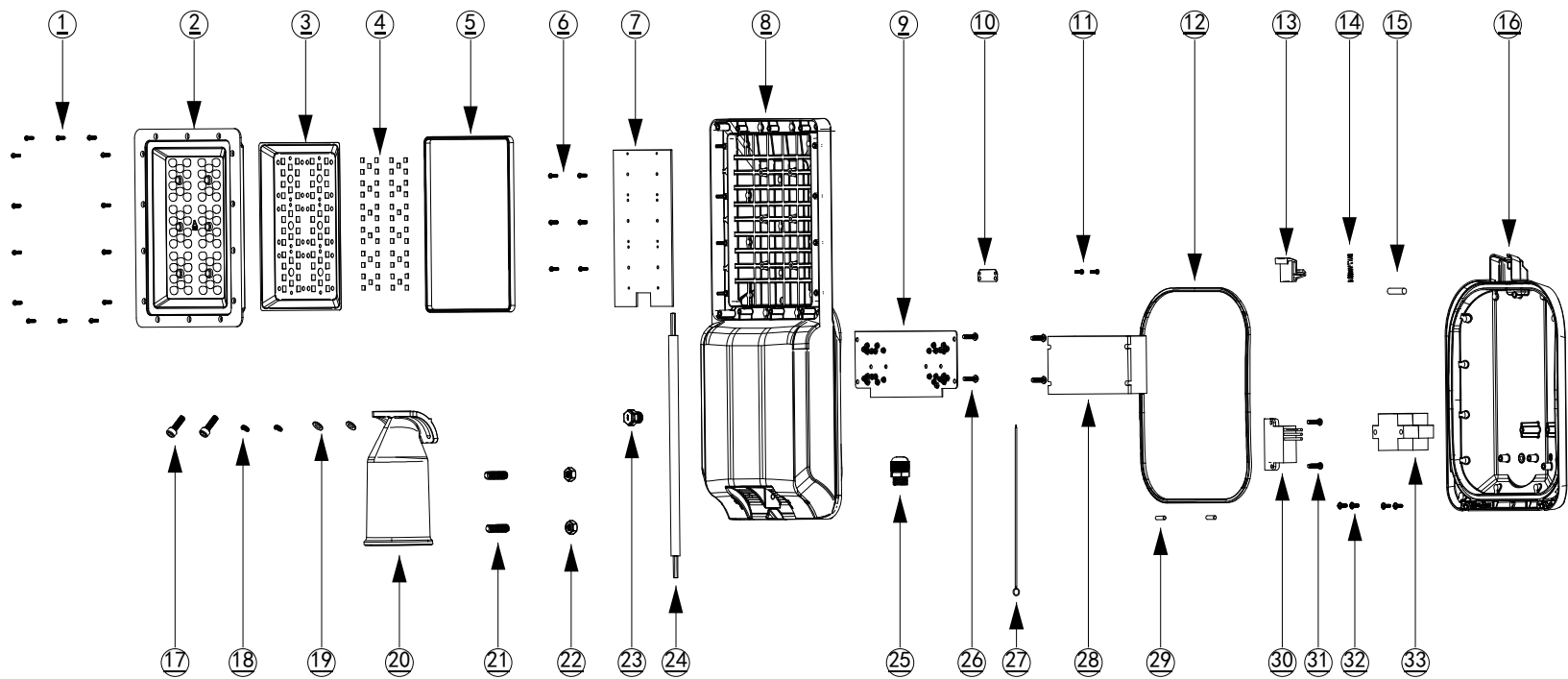

6B Street Lamp -75W Assembly Parts list		
Serial number	Assembly part name	Quantity
1	M3×10Round head cross screw	14
2	Lens (60-in-1, T2M)	1
3	Reflective paper	1
4	Light source -5050	60
5	Lens silicone ring	1
6	M3×6 round head cross screw	6
7	PCB board	1
8	Radiator main body	1
9	Power supply fixing board	1
10	Snap-on pressed sheet	1
11	M3×6 round head cross screw	2
12	Waterproof gasket for the power cover	1
13	Snap button	1
14	Spring	1
15	Horizontal column	1
16	Power cover	1
17	M6×18 hexagon socket screw	2
18	Spring pad	2
19	Flat gasket	2
20	10th generation 60 installation shaft	1
21	M8×25 hex socket screw	2
22	M8 nut	2
23	M5 waterproof and breathable valve	1
24	Wire (3 cores)	1
25	Waterproof connector	1
26	M4×6 round head cross screw with medium	5
27	Wire (grounded)	1
28	Power supply	1
29	Pin	2
30	Lightning arrester	1
31	M4×8 round head cross screw with medium	2
32	M3×6 round head cross screw with medium	4
33	Power-off switch	1

Feature description :

- 1.A practical street lamp with a separated rotating shaft, lamp body and installation shaft can adjust the pitch Angle of the lamp body according to the usage environment.
- 2. In terms of the light transmission method, glass and lenses can be selected. According to the environmental requirements of the customer's use, lenses can be customized.
- 3. The snap-on adopts a tool-free opening and press-type snap-on closing method, which is convenient for opening and closing the lamp body cover for internal inspection and maintenance.
- 4. Installing a waterproof and breathable valve on the outside of the lamp body can balance the pressure inside and outside the lamp body and reduce the temperature difference between them.

ust the pitch Angle of the lamp

vironmental requirements of

t for opening and closing

ssure inside and outside the

Bill of Materials (Glass style)

The diagram shows an exploded view of a street lamp assembly. Callouts 1-9 point to small fasteners and components. Callouts 10-18 point to the main lamp body, internal components like the PCB board and radiator, and the power cover. Callouts 19-26 point to the waterproof and breathable valve assembly. Callouts 27-35 point to the power supply, wiring, and mounting hardware.

Serial Number	Assembly part name	Quantity
1	M4×6 flat-head cross screw	4
2	Glass press sheet	4
3	Glass	1
4	Glass-silicone ring	1
5	M3×6 round head cross screw	6
6	Square lens	6
7	Reflective paper	1
8	Light source -5050	60
9	PCB board	1
10	Radiator main body	1
11	Power supply fixing board	1
12	Snap-on pressed sheet	1
13	M3×6 round head cross screw	2
14	Waterproof gasket for the power cover	1
15	Snap button	1
16	Spring	1
17	Horizontal column	1
18	Power cover	1
19	M6×18 hexagon socket screw	2
20	Spring pad	2
21	Flat gasket	2
22	The 60th installation shaft of the 10th generation	1
23	M8×25 hex socket screw	2
24	M8 nut	2
25	M5 waterproof and breathable valve	1
26	Wire (3 cores)	1
27	Waterproof connector	1
28	M4×6 round head cross screw with medium	5
29	Wire (grounded)	1
30	Power supply	1
31	Pin	2
32	Lightning arrester	1
33	M4×8 round head cross screw with medium	2
34	M3×6 round head cross screw with medium	4
35	Power-off switch	1

Feature description :

- 1.A practical street lamp with a separated rotating shaft, lamp body and installation shaft can adjust the pitch Angle of the lamp body according to the usage environment.

2. In terms of the light transmission method, glass and lenses can be selected. According to the environmental requirements of the customer's use, lenses can be customized.

3. The snap-on adopts a tool-free opening and press-type snap-on closing method, which is convenient for opening and closing the lamp body cover for internal inspection and maintenance.

4. Installing a waterproof and breathable valve on the outside of the lamp body can balance the pressure inside and outside the lamp body and reduce the temperature difference between them.
- ust the pitch Angle of the lamp

vironmental requirements of

t for opening and closing

ssure inside and outside the

Application



Place of use

- Main road
- Expressway
- Urban roads
- Overpass
- Sidewalk
- Square
- School
- Residential area
- Industrial park
- Park



A:Technical parameters

Technical specifications

Product model		BB-LD-50W-L4	BB-LD-75W-L4	BB-LD-100W-L4
Product size		481*175*113mm	549*197*110mm	592*246*110mm
Input voltage		AC100V-240V 50/60HZ		
Power		30-60W	70-80W	90-120W
Lamp bead model		EMC5050/EMC3030		
Glass + small square lens Style - Number of lamp beads	EMC5050(with 6-in-1 lens)	24pcs	36pcs	54pcs
	EMC5050(with 8-in-1 lens)	32pcs	48pcs	72pcs
	EMC5050(with 10-in-1 lens)	40pcs	60pcs	90pcs
	EMC3030(with 16-in-1 lens)	64pcs	96pcs	144pcs
	EMC3030(with 24-in-1 lens)	96pcs	144pcs	216pcs
Integrated lens model - number of lamp beads	EMC5050(Integrated Lens)	40pcs	60pcs	90pcs
Brightness	EMC5050(with 6-in-1 lens)	4800-9600LM	11200-12800LM	14400-19200LM
	EMC5050(with 8-in-1 lens)	5400-10800LM	12600-14400LM	16200-21600LM
	EMC5050(with 10-in-1 lens)	6000-12000LM	14000-16000LM	18000-24000LM
	EMC3030(with 16-in-1 lens)	4200-8400LM	9800-11200LM	12600-16800LM
	EMC3030(with 24-in-1 lens)	4800-9600LM	11200-12800LM	14400-19200LM
	EMC5050(Integrated Lens)	6000-12000LM	14000-16000LM	18000-24000LM
Color temperature	Warm white	3000-4000K		
	Natural white	4000-5000K		
	Cold white	5000-6000K		
Emission Angle	6-in-1 lens	T2S/T2M/T3M		
	8-in-1 lens	T2S/T2M/T3M		
	10-in-1 lens	T2S/T2M/T3M		
	16-in-1 lens	T2S/T2M/T3M		
	24-in-1 lens	T2S/T2M/T3M		
	EMC5050(Integrated Lens)	T2M		
Color rendering index		Ra>70		
Power supply efficiency		>90%		
Luminous efficacy of lamps	EMC5050(with 6-in-1 lens)	160lm/w		
	EMC5050(with 8-in-1 lens)	180lm/w		
	EMC5050(with 10-in-1 lens)	200lm/w		
	EMC3030(with 16-in-1 lens)	140lm/w		
	EMC3030(with 24-in-1 lens)	160lm/w		
	EMC5050(Integrated Lens)	200lm/w		
Power factor		>0.95		
Harmonic		≤15%		
Protection grade		IP66/IK08		
Net weight of the product		2.2kg	2.8kg	

A:Technical parameters (with intelligent control)

Technical specifications

Product model		BB-LD-50W-L4	BB-LD-75W-L4	BB-LD-100W-L4
Product size		481*175*186mm	549*197*183mm	592*246*183mm
Input voltage		AC100V-240V 50/60HZ		
Power		30-60W	70-80W	90-120W
Lamp bead model		EMC5050/EMC3030		
Glass + small square lens Style - Number of lamp beads	EMC5050(with 6-in-1 lens)	24pcs	36pcs	54pcs
	EMC5050(with 8-in-1 lens)	32pcs	48pcs	72pcs
	EMC5050(with 10-in-1 lens)	40pcs	60pcs	90pcs
	EMC3030(with 16-in-1 lens)	64pcs	96pcs	144pcs
	EMC3030(with 24-in-1 lens)	96pcs	144pcs	216pcs
Integrated lens model - number of lamp beads	EMC5050(Integrated Lens)	40pcs	60pcs	90pcs
Brightness	EMC5050(with 6-in-1 lens)	4800-9600LM	11200-12800LM	14400-19200LM
	EMC5050(with 8-in-1 lens)	5400-10800LM	12600-14400LM	16200-21600LM
	EMC5050(with 10-in-1 lens)	6000-12000LM	14000-16000LM	18000-24000LM
	EMC3030(with 16-in-1 lens)	4200-8400LM	9800-11200LM	12600-16800LM
	EMC3030(with 24-in-1 lens)	4800-9600LM	11200-12800LM	14400-19200LM
	EMC5050(Integrated Lens)	6000-12000LM	14000-16000LM	18000-24000LM
Color temperature	Warm white	3000-4000K		
	Natural white	4000-5000K		
	Cold white	5000-6000K		
Emission Angle	6-in-1 lens	T2S/T2M/T3M		
	8-in-1 lens	T2S/T2M/T3M		
	10-in-1 lens	T2S/T2M/T3M		
	16-in-1 lens	T2S/T2M/T3M		
	24-in-1 lens	T2S/T2M/T3M		
	EMC5050(Integrated Lens)	T2M		
Color rendering index		Ra>70		
Power supply efficiency		>90%		
Luminous efficacy of lamps	EMC5050(with 6-in-1 lens)	160lm/w		
	EMC5050(with 8-in-1 lens)	180lm/w		
	EMC5050(with 10-in-1 lens)	200lm/w		
	EMC3030(with 16-in-1 lens)	140lm/w		
	EMC3030(with 24-in-1 lens)	160lm/w		
	EMC5050(Integrated Lens)	200lm/w		
Power factor		>0.95		
Harmonic		≤15%		
Protection grade		IP66/IK08		
Net weight of the product		2.35kg	2.95kg	

Technical specifications

B:Mechanical parameters

Power supply	Mean Well, Songsheng, Mophos, Infineon, etc
Shell processing	Integral die-cast housing
Material	ADC12/ Aluminum

C:Environmental parameters

Operating temperature range	-40°C ~ 50°C
Working humidity range	20% ~ 95%
Storage temperature range	-40°C ~ 75°C
Storage humidity range	10% ~ 80%

Photometric curve illuminance diagram

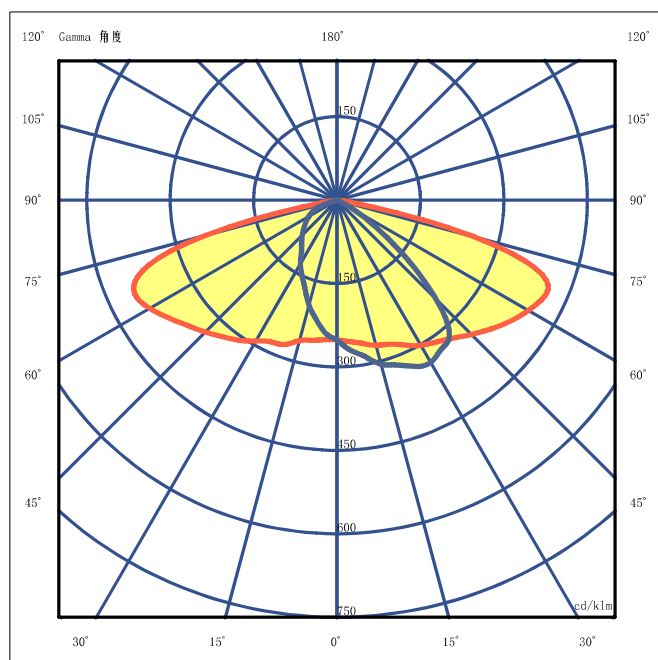

T2S

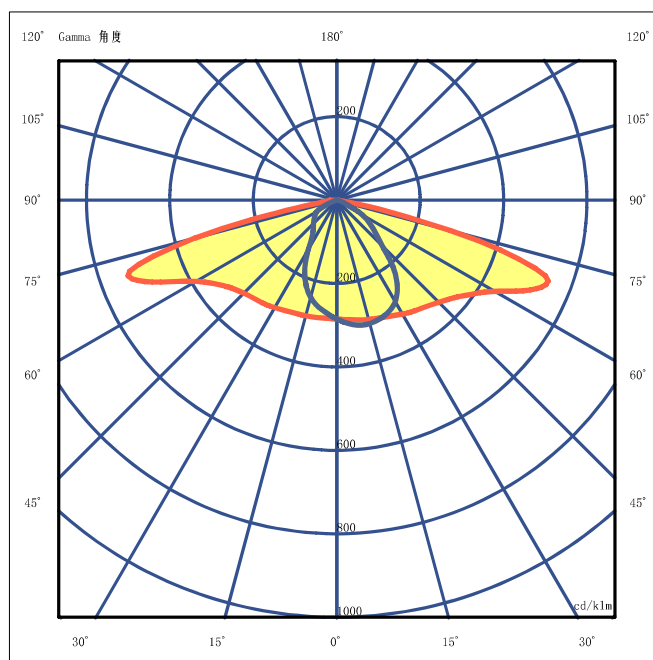

T2M

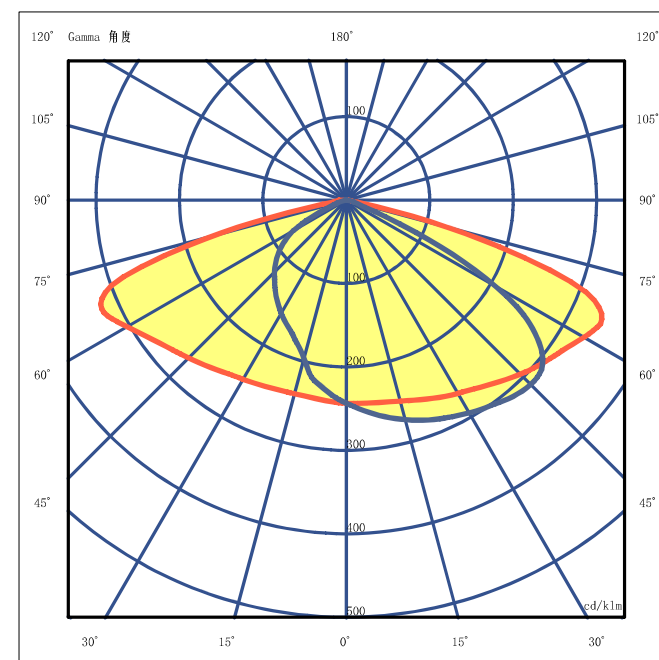

T3M

Product installation diagram

Installation hole 42/60MM

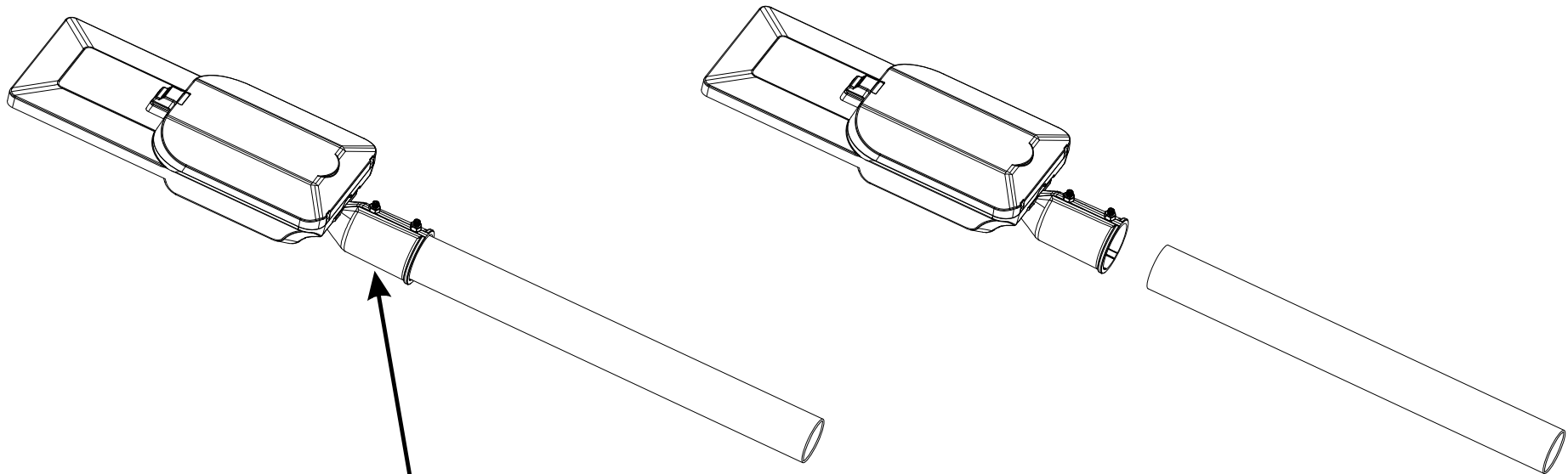

Replaceable 42/60mm mounting heads

Product installation diagram

Installation hole 42/60MM

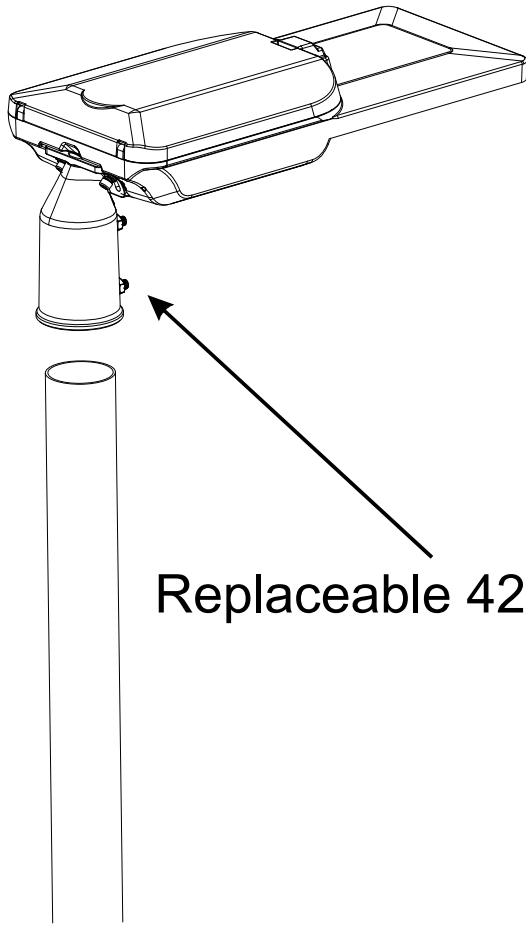

Replaceable 42/60mm mounting heads

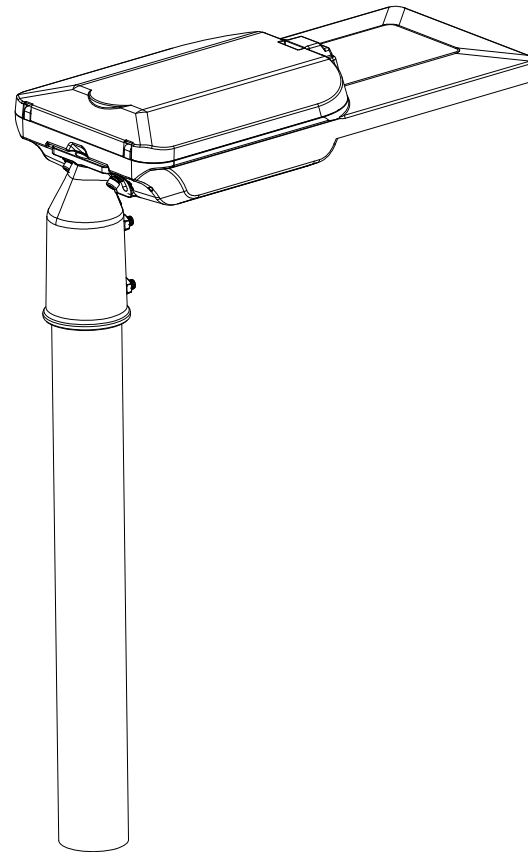

Product installation diagram

Installation hole 42/60MM

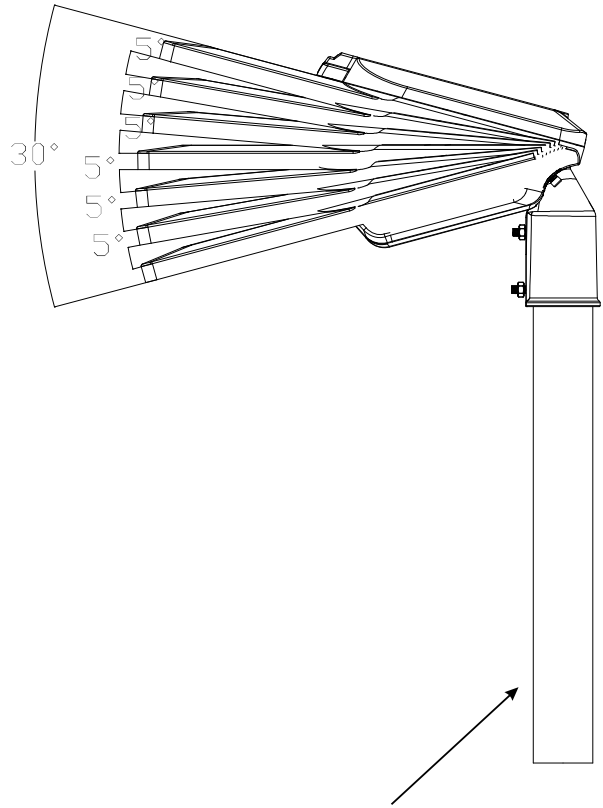

The installation shaft is installed at 90° and can rotate at intervals of 5°

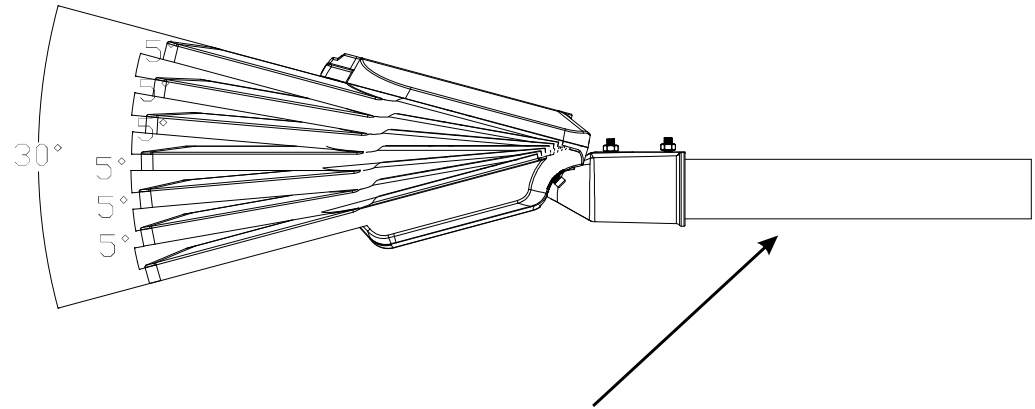

The installation shaft can be installed at 180° and rotated at intervals of 5°

Packaging

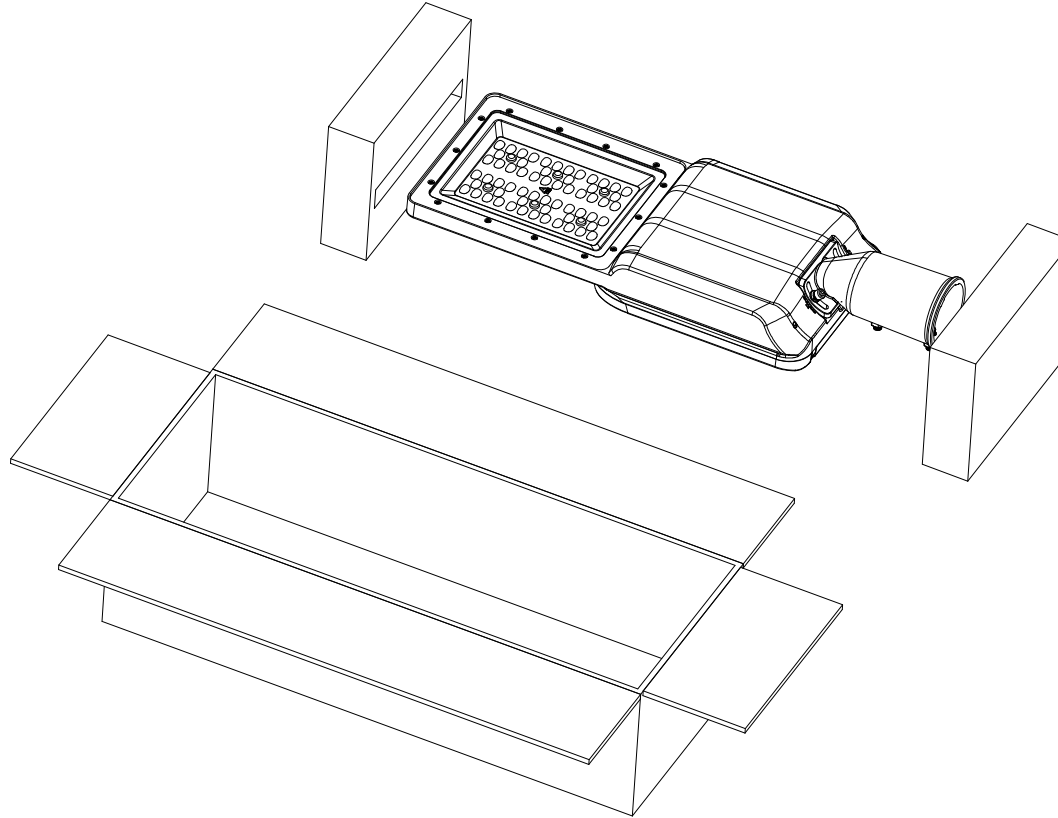

Model	carton size	Quantity	GW
BB-LD-50W-L4	523*204*164mm	1pcs	2.7kg
BB-LD-75W-L4	582*225*164mm	1pcs	3.3kg
BB-LD-100W-L4			

Packaging (with smart control)

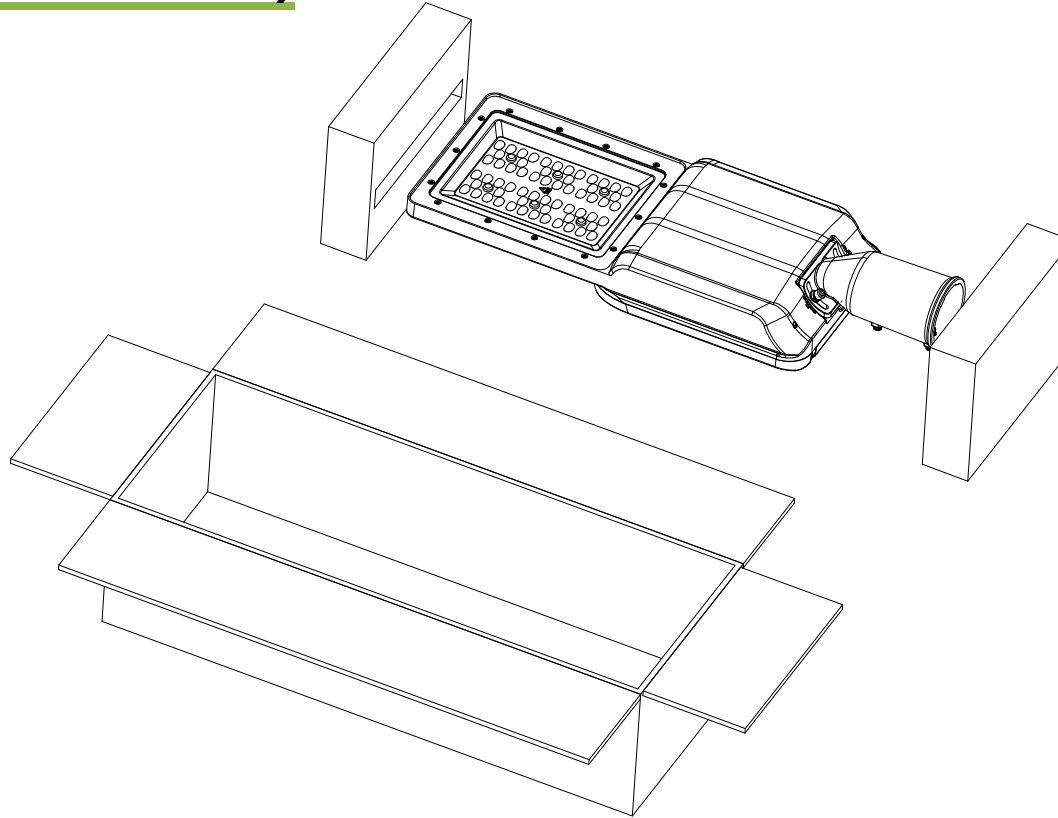

Model	carton size	Quantity	GW
BB-LD-50W-L4	523*204*164mm	1pcs	2.85kg
BB-LD-75W-L4	582*225*164mm	1pcs	3.45kg
BB-LD-100W-L4			

Warranty

All street lamps come with a 3-year warranty from the date of purchase

Warranty period

1. Under the terms of this guarantee, if the product malfunctions under normal use during the warranty period, GLT Optoelectronics will provide free maintenance services.
2. During the quality guarantee period, if any of the following faults occur, GLT Optoelectronics will provide paid repair services.
 - a. Malfunction or damage caused by force majeure.
 - b. General Electric faults or due to transportation or unloading.
 - c. Malfunction or damage is caused by incorrect use or non-compliance with the product's usage specifications.
 - d. Malfunction or damage is caused by removal, repair or modification without the authorization of the manufacturer.
3. Please ask the customer to package the repaired product properly. If the customer uses unpackaged or improperly packaged products, it will cause damage to the product

GLT Optoelectronics shall not be held responsible for any malfunction or damage.
4. GLT Optoelectronics reserves the final right of interpretation of the above terms.

Precautions

1. Before use, read the user manual carefully to ensure correct installation and proper power connection.
2. Before use, please carefully check. If any abnormal phenomenon is found during use, please contact our company .
3. When in use, the surface of the lamp will warm up to a certain extent, which is a normal phenomenon.
4. Do not disassemble the lamps privately; otherwise, it will be regarded as an automatic waiver of the warranty service.
5. For products with customized special functions, the corresponding sections in this manual are for reference only.